

# CoverLine

Electrical safety edge  
with ENT-20 contact strip

## Description

**ELE040/055A0J0**

Electrical safety edge with ENT-20 contact strip

## General data

<b>No. of cycles</b>	> 10'000 [with test piece $\varnothing$ 80 mm (3.15") at the same point]
<b>Switching capacity</b>	1 A / 42 V ADC
<b>Contact resistance</b>	0.5 ohm / m (0.5 ohm / 3 ft)
<b>Insulating strength</b>	1500 V AC
<b>Connection cable</b>	Twin-jacket PVC, $\varnothing$ 4.7 mm (0.19"), wires 2 x 0.34 mm <sup>2</sup> (AWG 22), min. bending radius 10 mm (0.4"), non-detachable. The cable must not be subjected to repetitive movements. Flexible cables on request.

## Technical data

<b>Rubber</b>	
<b>Foot</b>	Clicks into the side of the AP-G1 aluminium retainer
<b>Sealing lip</b>	None
<b>Material</b>	EPDM
<b>Aluminium Retainer</b>	AP-G1
<b>Packaging</b>	Box with 25 m (82 ft) length (rubber profile only)

<b>Safety edges</b>	
<b>Temperature range</b> <sup>1)</sup>	-20°C to +55°C (-4° F to 130° F)
<b>Actuation Distance</b> <sup>2)</sup>	9 mm (0.35")
<b>Actuation Force</b> <sup>2)</sup>	100 N (22 lbf)
<b>Overtravel</b> <sup>2)</sup>	
at 250 N	12 mm (0.47")
at 400 N	16 mm (0.63")
<b>Switching angle</b> <sup>2)</sup>	2 x 45°
<b>Bending angle</b>	A 30° / B 0° / C 0°
<b>Min. bending radius</b>	D 1000 mm / E 400 mm (D 40" / E 16")
<b>Max. length</b>	12 m (40 ft)
<b>Max. applicable force</b> <sup>2)</sup>	500 N (112 lbf)
<b>Protection class</b>	IP65
<b>Totzone</b> <sup>2)</sup>	20 mm (0.8")
<b>Non-active endzone</b> <sup>2)</sup>	40 mm (1.6")
<b>Installation</b>	Please refer to the installation instructions for recommended practices
<b>Standards conformity</b>	EN 12978

<sup>1)</sup> EN 1760-2: -10°C to +55°C (14°F to 130°F) <sup>2)</sup> Values at 23°C (73°F), with test piece  $\varnothing$  80 mm (3.15"), measuring point C3 acc. to EN 1760-2

## Dimensions / bending angles / bending radii

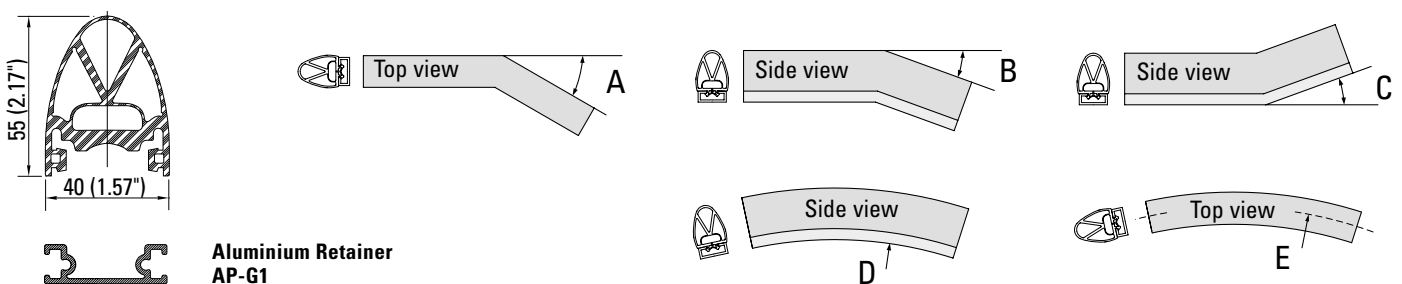

# CoverLine

**Ordering information (example)**

**ELE040/055A0J0 / 1 / 2500 / 2**

<p><b>Type</b> ELE040/055A0J0</p>	<p><b>End piece / aluminium</b></p> <ol style="list-style-type: none"> <li>1 End piece 1: with cable End piece 2: 8K2 resistor Safety edge with aluminium retainer</li> <li>2 End piece 1: with cable End piece 2: with cable Safety edge with aluminium retainer</li> <li>3 End piece 1: with cable End piece 2: special Safety edge with aluminium retainer</li> <li>4 End piece 1: with cable End piece 2: 8K2 resistor Safety edge without aluminium retainer</li> <li>5 End piece 1: with cable End piece 2: with cable Safety edge without aluminium retainer</li> <li>6 End piece 1: with cable End piece 2: special Safety edge without aluminium retainer</li> </ol>	<p><b>Length</b> Length of safety edge in mm</p>	<p><b>Cable length</b> End piece cabel length in whole meters</p>
---------------------------------------	---	--	---

**Other data (optional):**

- Terminating resistor (standard: 8.2 kohm)
- With or without end cap (standard: with cap)
- Position of cable exit, optionally 1–4

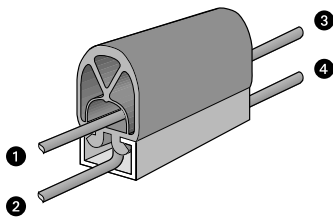

**Cable exit**

**Caution:**

The standard cable must not be used in applications with repetitive movements. Flexible cables on request.

**Your contact**

**Bircher Reglomat AG**  
 Wiesengasse 20  
 CH-8222 Beringen  
 Phone +41 52 687 11 11  
 Fax +41 52 687 12 10  
 info@bircher.com  
 www.bircher-reglomat.com

**Note**  
 Technical details and recommendations concerning our products are based on experience and are intended as an aid for the user. Details stated in our brochures and data sheets do not guarantee special properties of the products. This does not apply to special product properties confirmed in writing or individually. Subject to technical alterations.

# CoverLine

Electrical safety edge  
with ENT-20 contact strip

## Description

### ELE040/080A0J0

Electrical safety edge with ENT-20 contact strip

## General data

<b>No. of cycles</b>	> 10'000 [with test piece $\varnothing$ 80 mm (3.15") at the same point]
<b>Switching capacity</b>	1 A / 42 V ADC
<b>Contact resistance</b>	0.5 ohm / m (0.5 ohm / 3 ft)
<b>Insulating strength</b>	1500 V AC
<b>Connection cable</b>	Twin-jacket PVC, $\varnothing$ 4.7 mm (0.19"), wires 2 x 0.34 mm <sup>2</sup> (AWG 22), min. bending radius 10 mm (0.4"), non-detachable. The cable must not be subjected to repetitive movements. Flexible cables on request.

## Technical data

<b>Rubber</b>	
<b>Foot</b>	Clicks into the side of the AP-G1 aluminium retainer
<b>Sealing lip</b>	None
<b>Material</b>	EPDM
<b>Aluminium Retainer</b>	AP-G1
<b>Packaging</b>	Box with 25 m (82 ft) length (rubber profile only)

<b>Safety edges</b>	
<b>Temperature range</b> <sup>1)</sup>	-20°C to +55°C (-4° F to 130° F)
<b>Actuation Distance</b> <sup>2)</sup>	5 mm (0.2")
<b>Actuation Force</b> <sup>2)</sup>	120 N (26.4 lbf)
<b>Overtravel</b> <sup>2)</sup>	
at 250 N	29 mm (1.14")
at 400 N	33 mm (1.3")
<b>Switching angle</b> <sup>2)</sup>	2 x 45°
<b>Bending angle</b>	A 30° / B 0° / C 0°
<b>Min. bending radius</b>	D 1000 mm / E 500 mm (D 40" / E 20")
<b>Max. length</b>	12 m (40 ft)
<b>Max. applicable force</b> <sup>2)</sup>	500 N (112 lbf)
<b>Protection class</b>	IP65
<b>Dead endzone</b> <sup>2)</sup>	20 mm (0.8")
<b>Non-active endzone</b> <sup>2)</sup>	40 mm (1.6")
<b>Installation</b>	Please refer to the installation instructions for recommended practices
<b>Standards conformity</b>	EN 12978

<sup>1)</sup> EN 1760-2: -10°C to +55°C (14°F to 130°F) <sup>2)</sup> Values at 23°C (73°F), with test piece  $\varnothing$  80 mm (3.15"), measuring point C3 acc. to EN 1760-2

## Dimensions / bending angles / bending radii

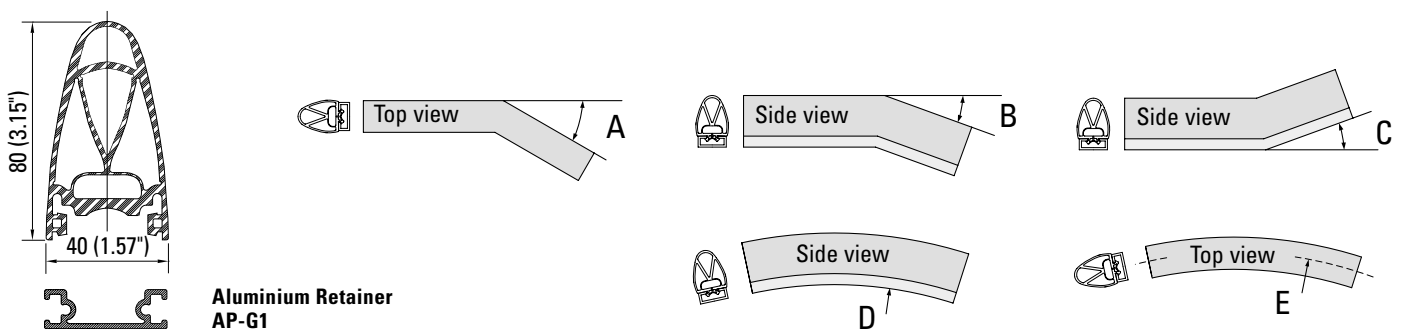

# CoverLine

**Ordering information (example)**

**ELE040/080A0J0 / 1 / 2500 / 2**

**Type**  
ELE040/080A0J0

**End piece / aluminium**

- 1 End piece 1: with cable  
End piece 2: 8K2 resistor  
Safety edge with aluminium retainer
- 2 End piece 1: with cable  
End piece 2: with cable  
Safety edge with aluminium retainer
- 3 End piece 1: with cable  
End piece 2: special  
Safety edge with aluminium retainer
- 4 End piece 1: with cable  
End piece 2: 8K2 resistor  
Safety edge without aluminium retainer
- 5 End piece 1: with cable  
End piece 2: with cable  
Safety edge without aluminium retainer
- 6 End piece 1: with cable  
End piece 2: special  
Safety edge without aluminium retainer

**Length**  
Length of safety edge in mm

**Cable length**  
End piece cable length in whole meters

**Other data (optional):**

- Terminating resistor (standard: 8.2 kohm)
- With or without end cap (standard: with cap)
- Position of cable exit, optionally 1–4

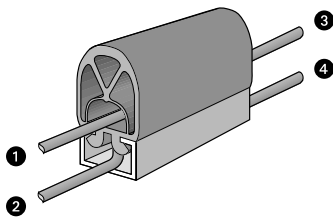

**Cable exit**

**Caution:**  
The standard cable must not be used in applications with repetitive movements. Flexible cables on request.

**Your contact**

**Bircher Reglomat AG**  
Wiesengasse 20  
CH-8222 Beringen  
Phone +41 52 687 11 11  
Fax +41 52 687 12 10  
info@bircher.com  
www.bircher-reglomat.com

**Note**  
Technical details and recommendations concerning our products are based on experience and are intended as an aid for the user. Details stated in our brochures and data sheets do not guarantee special properties of the products. This does not apply to special product properties confirmed in writing or individually. Subject to technical alterations.

# CoverLine

Electrical safety edge  
with ENT contact strip

## Description

**ELE040/105A0J**

Electrical safety edge with ENT contact strip

## General data

<b>No. of cycles</b>	> 10'000 [with test piece $\varnothing$ 80 mm (3.15") at the same point]
<b>Electrical data</b>	See data sheet "contact strips"
<b>Connection cable</b>	Twin-jacket PVC, $\varnothing$ 4.7 mm (0.19"), wires 2 x 0.34 mm <sup>2</sup> (AWG 22), min. bending radius 10 mm (0.4"), non-detachable. The cable must not be subjected to repetitive movements. Flexible cables on request.

## Technical data

Rubber profile	
<b>Foot</b>	Clicks into the side of the AP-G1 aluminium retainer
<b>Sealing lip</b>	None
<b>Material</b>	EPDM
<b>Aluminium Retainer</b>	AP-G1
<b>Weight</b> (only Alu rail)	0.33 kg/m (0.22 lb/ft)
<b>Packaging</b>	Box with 25 m (82 ft) length

Safety edges	
<b>Temperature range</b> <sup>1)</sup>	-30°C to +55°C (-22° F to 130° F)
<b>Actuation Distance</b> <sup>2)</sup>	5 mm (0.2")
<b>Actuation Force</b> <sup>2)</sup>	70 N (15.7 lbf)
<b>Overtravel</b> <sup>2)</sup>	
at 250 N	37 mm (1.46")
at 400 N	53 mm (2")
<b>Max. length</b>	6 m (20 ft)
<b>Weight</b> (without Alu rail)	1.26 kg/m (0.85 lb/ft)
<b>Max. applicable force</b> <sup>2)</sup>	500 N (112 lbf)
<b>Protection class</b>	IP65
<b>Dead endzone</b> <sup>2)</sup>	0 mm
<b>Non-active endzone</b> <sup>2)</sup>	0 mm
<b>Installation</b>	Please refer to the installation instructions for recommended practices
<b>Standards conformity</b>	EN 12978

<sup>1)</sup> EN 1760-2: -20°C to +55°C (-4°F to 130°F)    <sup>2)</sup> Values at 23°C (73°F), with test piece  $\varnothing$  80 mm (3.15"), measuring point C3 acc. to EN 1760-2

## Dimensions

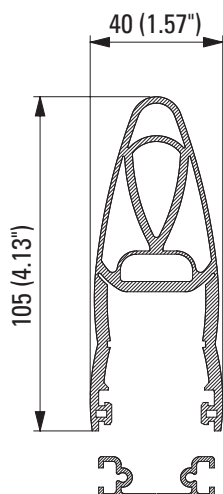

**Aluminium Retainer  
AP-G1**

# CoverLine

**Ordering information (example)**

**ELE040/105A0J 2 / 1 / 2500 / 2**

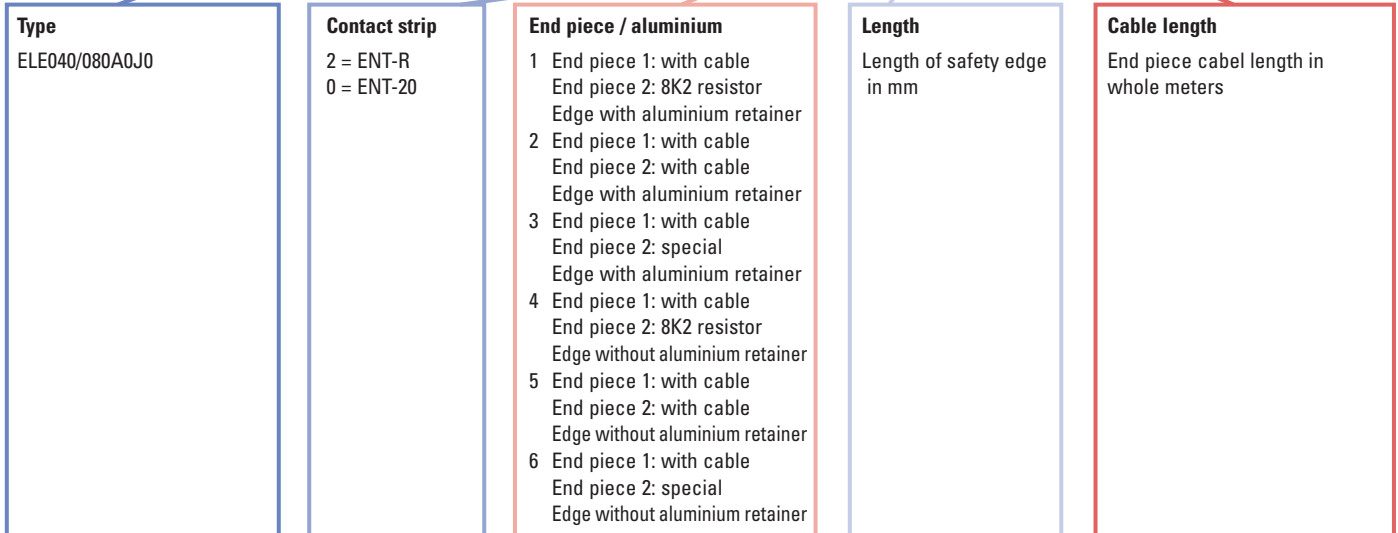

**Your contact**

**Bircher Reglomat AG**  
 Wiesengasse 20  
 CH-8222 Beringen  
 Phone +41 52 687 11 11  
 Fax +41 52 687 12 10  
 info@bircher.com  
 www.bircher-reglomat.com

**Note**  
 Technical details and recommendations concerning our products are based on experience and are intended as an aid for the user. Details stated in our brochures and data sheets do not guarantee special properties of the products. This does not apply to special product properties confirmed in writing or individually. Subject to technical alterations.